



深圳市国冶星光电子有限公司
SHENZHEN GUOYEXING OPTOELECTRONICS CO.,LTD.

承 认 书

SPECIFICATION FOR APPROVAL

客户名称Customer: _____

产品型号Model: _____ GYXM-2358CHO

企业号No.: _____ GYX-G-003

客户号Customer No: _____ DDCG0217

日期Date: _____ 2008-01-17

附产品规格书Enclosure is the specification

深圳市国冶星光电子有限公司
SHENZHEN GUOYEXING OPTOELECTRONICS CO.,LTD.

生产部 Production Dept.	质量部 Quality Dept.	工程部 Engineering Dept.	市场部 Marketing Dept.
张述花 zhangshuhua	程斯容 chengsirong	廖晶晶 liaojingjing	韩丽娟 hanlijuan

客户确认签名
APPROVED SIGNATURES

--	--	--	--

地址: 深圳市蛇口后海大道东角头工业区C座4楼 518067

Add: 4/F, Block C, Dongjiaotou Industrial Zone, Houhai Avenue, Shekou, Shenzhen.

电话Tel: 0086-755-26816353, 26816352

传真Fax: 0086-755-26686042

Email: gyx@gyx-led.com

Website: www.Gyx-led.com



GYXM-2358CHO

PACKAGE DIMENSIONS

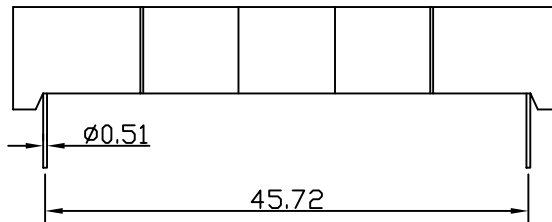
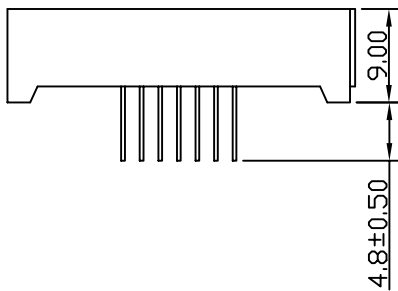
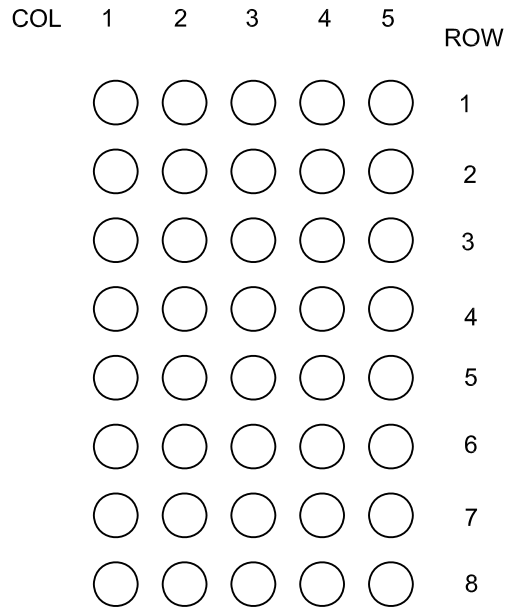
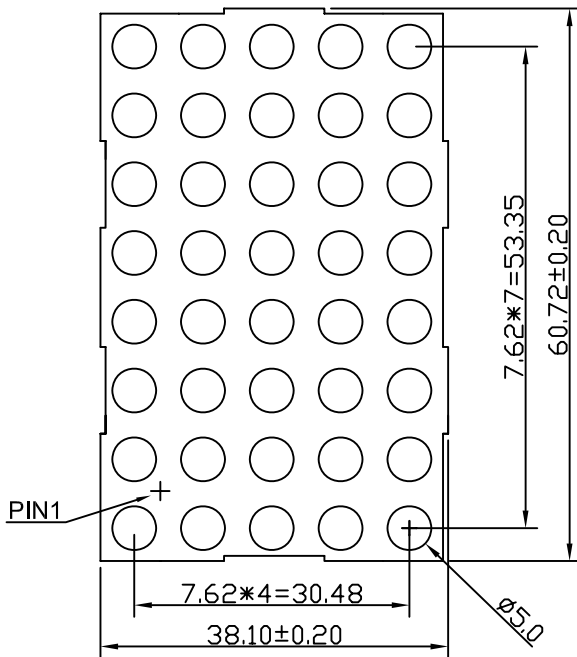

INTERNAL CIRCUIT DIAGRAM

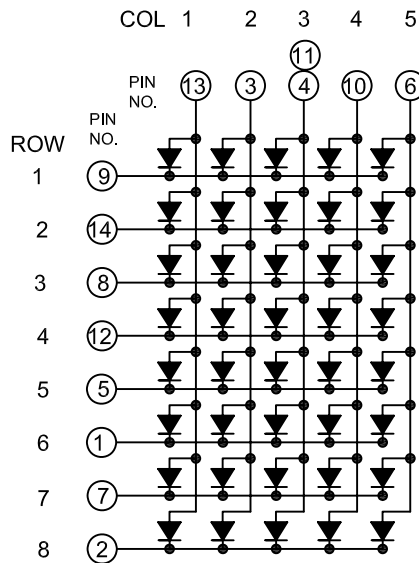

Notes:

1. All dimensions are in millimeters (inch), Tolerance is $\pm 0.25\text{mm}$ ($0.01''$) unless otherwise noted.
2. The specification may be changed without notice.



GENERAL INFORMATION

Part NO.	Chip Material	Emitting Color	Lens Type	Description
GYXM-2358CHO	AlGaInP	orange	Diffused	common Cathode

Electrical/Optical Characteristics at Ta=25°C

Parameter	Symbol	Typ.	Max.	Unit	Conditions
Luminous Intensity	I _v	40	50	mcd	I _F =20mA
Peak Wavelength	λ _P	—	—	nm	I _F =20mA
Dominant Wavelength	λ _D	600	605	nm	I _F =20mA
Spectral Line Half-Width	Δλ	—	—	nm	I _F =20mA
Forward Voltage	V _F	1.7	2.5	V	I _F =20mA
Reverse Current 成品反向电流	I _R	50	—	μA	V _R =5V

Absolute Maximum Ratings at Ta=25°C

Parameter	Symbol	Maximum Rating	Unit
Power Dissipation	P _d	75	mW
Forward Current	I _F	20	mA
Peak Forward Current(1)	I _F (Peak)	120	mA
Reverse Voltage	V _R	5	V
Operating Temperature	T _{opr}	-40° c+80° c	
Storage Temperature	T _{stg}	-40° c+80° c	
Lead Solder Temperature(2)	T _{sol}	260° c for 5 seconds	

Notes:

- 1/10 duty cycle, 0.1ms pulse width.
- 2mm below package base.